

**VISUAL FAULT LOCATOR**

光纤通光笔

MODEL NO. : **VFL-250**



**Feature**

- Visual Fault Locator is used for locating broken point in fibers .
- Visual Fault Locator is equipped with a 650-nm visible laser diode , can be operated in continuous or pulse modes for clear noticeable results .
- One green LED indicator shows the operating mode .
- Power switch on the end for battery on / off .
- Push button operate CW / Mod. (2.5 Hz frequency) / pause .
- Clip pocket-size pen design .
- Protective cap for extra protection .
- Low Battery Indicator: The Status LED will turn to red when batteries are low.

**Specification**

Central Wavelength	650 +/- 10 nm
Output Power	>0.5mW into Single-mode fiber
Spectral Width	< 10 nm
Transmission	CW or 2.5 Hz pulse
Batteries	2 x AAA Alkaline batteries
Operating Temp.	0 - 50 °C
Detecion Distance	< 6 Km
Dimension / Weight	13.5 mm X 170 mm / 88 g
Light Source	Class 3A laser diode
Suit for	φ2.5 mm Ferrule

**VISUAL FAULT LOCATOR ADAPTOR**

光纤通光笔转接适配器

MODEL NO. : **VFL-ADP**



**Feature**

- Visual Fault Locator Adaptor Convert  $\phi 2.5$  to  $\phi 1.25$  mm Ferrule .
- The Adaptor Can Screw Lock with VFL-250 ( $\phi 2.5$  mm Locator) To Use on  $\phi 1.25$  mm Ferrule Test.

**Specification**

Central Wavelength  $\phi 13.4$  mm x 22.9 mm

Weight 10 g

**VFL-ADP**

**Dimension :**

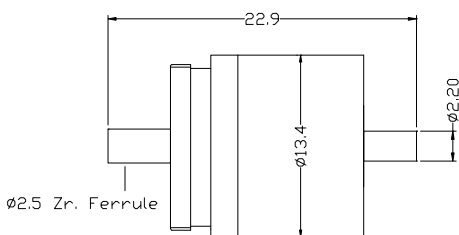

Example :

VFL-ADP is Connected with VFL-250

